

## TERMINAL ADAPTERS

1/2" - 1-1/4" Tapered Thread; 1-1/2" - 6" Non-Tapered Thread

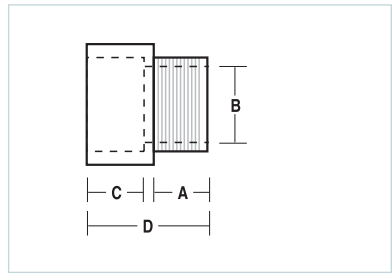

| Size (inches) | Part Number | Product Code | A (inches) | B (inches) | C (inches) | D (inches) |
|---------------|-------------|--------------|------------|------------|------------|------------|
| 1/2           | TA10        | 077021       | 0.700      | 0.591      | 0.750      | 1.550      |
| 3/4           | TA15        | 077022       | 0.675      | 0.790      | 1.000      | 1.750      |
| 1             | TA20        | 077023       | 0.625      | 1.000      | 1.115      | 1.860      |
| 1-1/4         | TA25        | 077024       | 0.640      | 1.311      | 1.300      | 2.125      |
| 1-1/2         | TA30        | 077025       | 0.725      | 1.530      | 1.425      | 2.250      |
| 2             | TA35        | 077026       | 0.800      | 1.970      | 1.150      | 2.100      |
| 2-1/2         | TA40        | 077027       | 0.800      | 2.346      | 1.900      | 2.930      |
| 3             | TA45        | 077028       | 0.815      | 2.915      | 2.000      | 3.055      |
| 3-1/2         | TA50        | 077029       | 1.000      | 3.385      | 1.715      | 3.055      |
| 4             | TA55        | 077030       | 0.815      | 3.850      | 1.990      | 3.215      |
| 5             | TA60        | 077031       | 1.105      | 4.810      | 2.000      | 5.985      |
| 6             | TA65        | 077032       | 1.105      | 5.825      | 2.130      | 6.500      |

## FEMALE ADAPTERS

NPT Tapered Thread

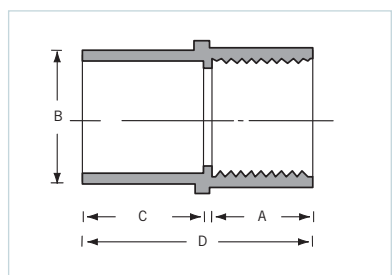

| Size (inches) | Part Number | Product Code | A (inches) | B (inches) | C (inches) | D (inches) |
|---------------|-------------|--------------|------------|------------|------------|------------|
| 1/2           | FA10        | 077041       | 0.800      | 0.620      | 0.825      | 1.725      |
| 3/4           | FA15        | 077042       | 0.800      | 0.820      | 1.000      | 1.900      |
| 1             | FA20        | 077043       | 1.000      | 1.065      | 1.200      | 2.300      |
| 1-1/4         | FA25        | 077044       | 1.015      | 1.395      | 1.300      | 2.425      |
| 1-1/2         | FA30        | 077045       | 1.050      | 1.575      | 1.290      | 2.440      |
| 2             | FA35        | 077046       | 1.075      | 2.050      | 1.375      | 2.550      |
| 2-1/2         | FA40        | 077047       | 1.675      | 2.470      | 1.985      | 3.760      |
| 3             | FA45        | 077048       | 1.630      | 3.090      | 2.150      | 4.100      |
| 3-1/2         | FA50        | 077049       | 1.800      | 3.540      | 2.000      | 3.985      |
| 4             | FA55        | 077050       | 1.755      | 4.025      | 2.185      | 4.210      |
| 5             | FA60        | 077051       | 2.065      | 5.035      | 3.000      | 5.240      |
| 6             | FA65        | 077052       | 2.065      | 6.045      | 3.000      | 5.235      |